



## EFFECTIVE THERMAL RESISTANCES OF ASSEMBLIES BCBC 2018 vs 2022 Prescriptive Energy Step Code Requirements

Suite D, 180 North Third Avenue, Williams Lake, BC V2G 2A4  
Unit 3 - 170 Cedar Avenue, Box 2260, 100 Mile House, BC V0K 2E0  
102 - 410 Kinchant Street, Quesnel, BC V2J 7J5

Ph: 250-392-3351 Fax: 250-392-2812  
Ph: 250-395-3838 Fax: 250-395-4898  
Ph: 250-992-7400 Fax: 250-992-7414

Effective Thermal Resistance of Above-ground Opaque Assemblies in Dwelling Units	BCBC 2018		Energy Step Code 2022	
	RSI	R-Value	RSI	R-Value
Ceilings below attics	8.67	49	10.43	59
Cathedral ceilings	4.67	27	4.67	27
Flat roofs	4.67	27	5.28	30
Walls	3.08	17	3.69	21
Floors over unheated spaces	4.67	27	4.67	27
Effective Thermal Resistance of Assemblies Below-Grade or in Contact with the Ground in Dwelling Units	RSI	R-Value	RSI	R-Value
Foundation walls	2.98	17	3.97	22.5
Unheated floors				
Below frost line	0	0	2.98	17
Above frost line	1.96	11	3.46	19.6
Heated floors	2.32	14	3.46	19.6
Slabs on grade with integral footing	1.96	11	3.46	19.6
Required Thermal Characteristics of Fenestration for Buildings containing dwelling units	U-Value	R-Value	U-Value	R-Value
	1.6	3.5	1.22	4.7

# Climate Zone 6

**Cathedral Roof** No Change  
Now 4.67

**Flat Roof** Was 4.67  
Now 5.28

**Glazing** Was U1.60  
Now U1.22

**Exposed Floor** No change  
Now 4.67

**Foundation Walls** Was 2.98  
Now 3.97

**Heating and Ventilation**  
Heat Pump  
Or  
HRV 75% SRE

**ACH**  
Assumed value  
No testing required

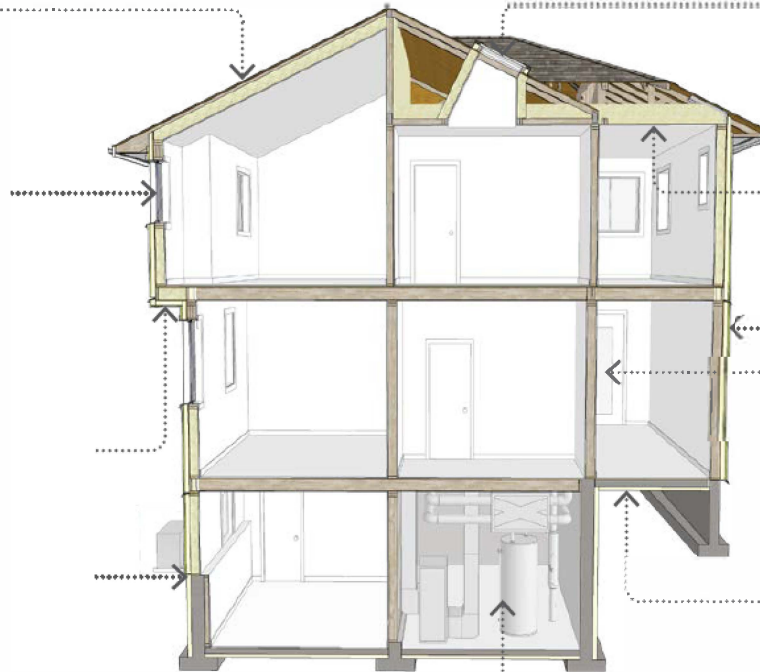

**Skylights** Was 2.7  
Now 2.75

**Roofs** Was 8.67  
Now 10.43

**Walls** Was 3.08  
Now 3.69

**Glazed Doors** Was U1.6  
Now U1.61

**Slab**  
Below Frost Was uninsulated  
Now 3.46

Above Frost Was 1.96  
Now 3.46

Heated Was 2.32  
Now 3.46