

BC Register of Historic Places: PDF Data Entry Template

For more information please refer to *Preparing and Submitting Records for the BC Register of Historic Places* guideline document.

☐ denotes a mandatory field

COMMON NAME

Knoll House

Unique Provincial ID

Other Name(s)

LOCATION

Street Address

Municipality

Locality

PID#

Cariboo Regional District

014-091-208

Location Description

District Lot 258, Coast Range 3, EXC PCL A (86318M)

Latitude

52.06'10.05 N

Longitude

124.9'55.6 W

STATEMENT OF SIGNIFICANCE

Description

The Knoll House is a weathered, hand-hewn square timbered structure currently located on Chilanko Creek near Chilanko Forks. The building consists of a single-story sod-roofed section with a two-story Gambrel (barn-style) roofed addition, connected by a covered walkway. The historic place consists of the building on its footprint only.

Heritage Value

The Knoll House is valued as a rare example of early Norwegian settlement in the Chilcotin, which helped establish rural ranching in the region, which today is a vital part of the economy. Built entirely from locally obtained materials, this historic ranch house is valued as an example of the independent, resourceful rural character of early settlers in the central Chilcotin plateau. The Knoll House is valued for its use for many years as the home and ranch headquarters of the prominent ranching Knoll family.

The hand-hewn timbers and locking dovetailed corner construction are valued as an example of skilled turn-of-the-century European craftsmanship. The adze-hewn beams and the Norwegian saddlenotched corners in the original section are valued as rare examples of early Norwegian craftsmanship.

The Knoll House is also valued as one of the last remaining structures built by the first non-aboriginal settlers in the Chilcotin in the late nineteenth century. The first, single storey section was built by Mr. & Mrs. Ole Nygard, who arrived with a group of Norwegian settlers who settled in Hagensborg in 1894, fleeing the recession in the eastern US. The Nygards raised cattle at Chilanko Forks, but went back to the Bella Coola valley in 1914 after selling to Arthur Knoll.

The addition, built by the Knoll family, is valued for its evidence of the evolution of the building footprint in response to the needs of the growing family.

Character-defining Elements

1. Original sod roof on the first single-storey section
2. Hand-hewn squared timbers and locking dovetail corners
3. Original section hand-crafted by adze, as evident by the perfectly square smooth timbers
4. Two-storey standing cement chimney
5. Hand-crafted staircase
6. Cedar-shaked gambrel roof on the addition
7. Norwegian saddlenotched corners.

Documentation Location

Cariboo Regional District



Heritage Branch

OTHER INFORMATION

Function

Type

Residence: Single Dwelling

Select

Select

Era

Historic

Select

Select

Contributing Resources

Type

1 Building

Select

Select

Category of Property

Private

Themes

Peopling the Land: Settlement

Select

Select

Select

Architect/Builder

Name

Knoll family

Type

Architect/Designer

Select

Select

Associated Dates

Type

Construction (circa)

From

1890

To

1900

Select

Select

FORMAL RECOGNITION

Recognition Type

Community Heritage Register

Select

Reference

12-07B-45

Recognition Date

July 13, 2012

IMAGES

File Name

Knoll House - Front.
jpg

Image Type

Contemporary Photograph

Select

Select

Description

Front view of Knoll House, West Chilcotin, 2012

Caption

Front view

Date

2012

LINKS

Type

Select

Select

Select

URL

Description

COMMENTS AND INFORMATION

NOTE: Information in this field is for use by the local government. It is not added to the BC or Canadian Registers of Historic Places
Knoll House, West Chilcotin. This is the first property west of the Fraser River that has been included on the heritage registry.

Author

Rick Brundrige

Date Modified

August 27, 2012

Questions? Contact:

Susan Green, Registrar
250-356-1435
Susan.J.Green@gov.bc.ca

Carla Jack, Register Officer
250-387-2262
Carla.Jack@gov.bc.ca



Heritage Branch



Legend

- Landfills and Transfer Stations
- LANDFILL
- TRANSFER STATION
- WOOD YARD
- Highways
- 911 Roads
- Parcels
- Eas_And_Municipalities
- First Nations Reserves
- Rivers
- Lakes
- Parks and Protected Areas
- CaribooRD

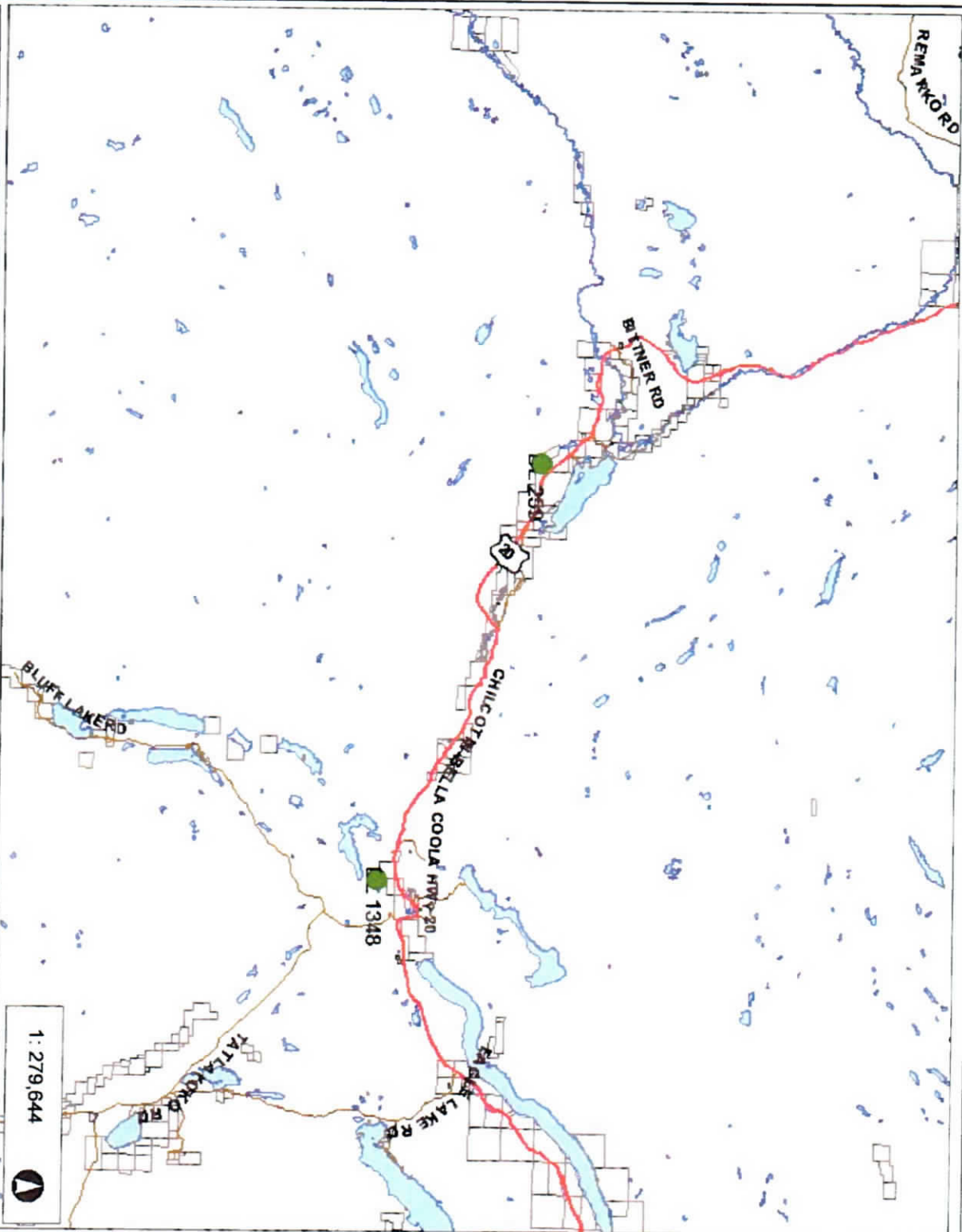

1: 279,644



Notes

8.8
0
4.41
8.8 Miles

NAD_1983_UTM_Zone_10N
CRD GIS Department

This map is a user generated static output from an Internet mapping site and is for reference only. Data layers that appear on this map may or may not be accurate, current, or otherwise reliable.

THIS MAP IS NOT TO BE USED FOR NAVIGATION

Knoll House_2?

Coordinates



Legend

- Landfills and Transferstations
- LANDFILL
- TRANSFER STATION
- WOOD YARD
- 911 Roads
- Parcels
- EAs_And_Municipalities
- First Nations Reserves
- Rivers
- Lakes
- Parks and Protected Areas
- CaribooRD

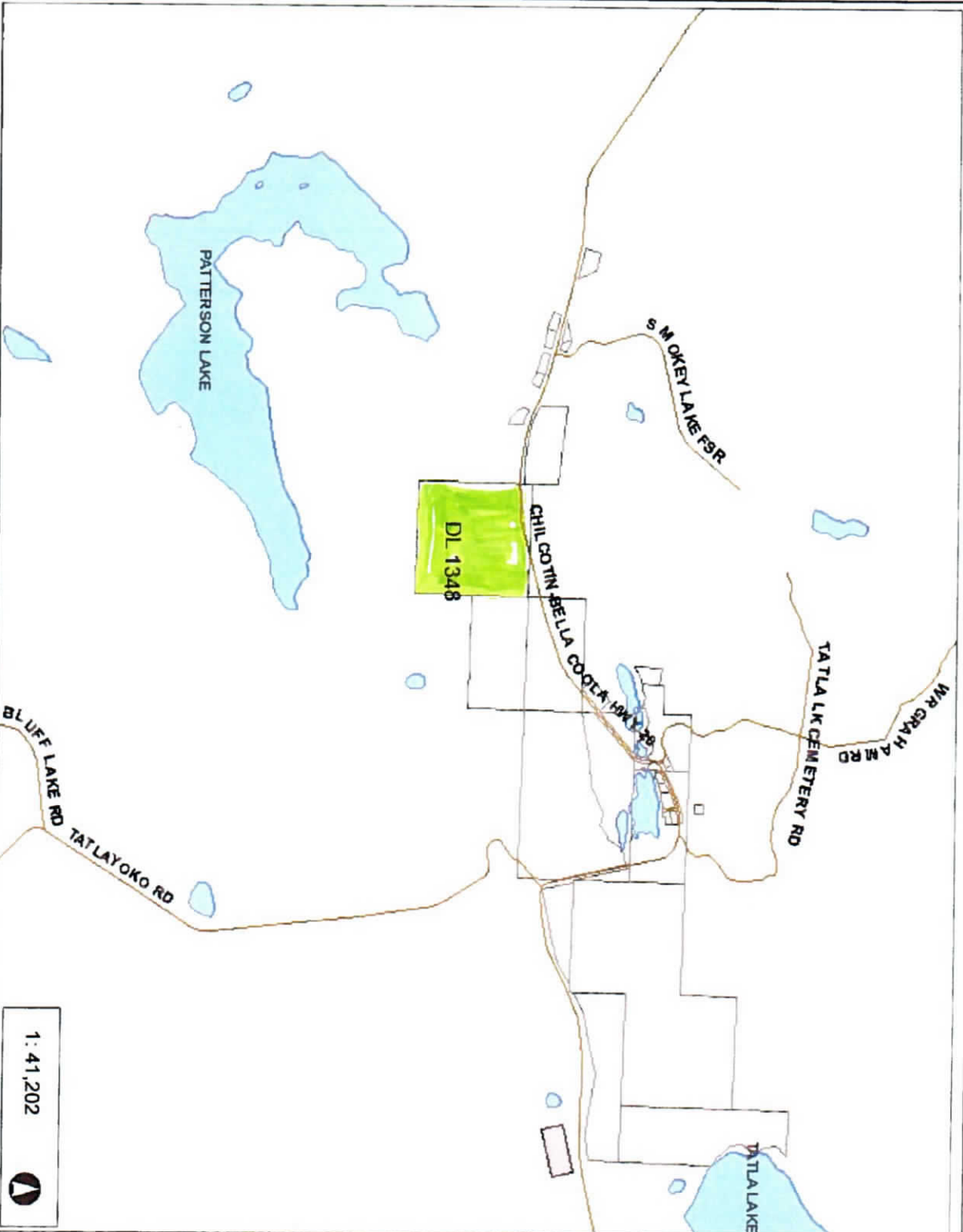

1: 41,202



Notes

Notes

This map is a user generated static output from an Internet mapping site and is for reference only. Data layers that appear on this map may or may not be accurate, current, or otherwise reliable.

THIS MAP IS NOT TO BE USED FOR NAVIGATION

1.3 0 0.65 1.3 Miles

NAD_1983_UTM_Zone_10N

CRD GIS Department

Knoll House

Legal parcel in S.O.S

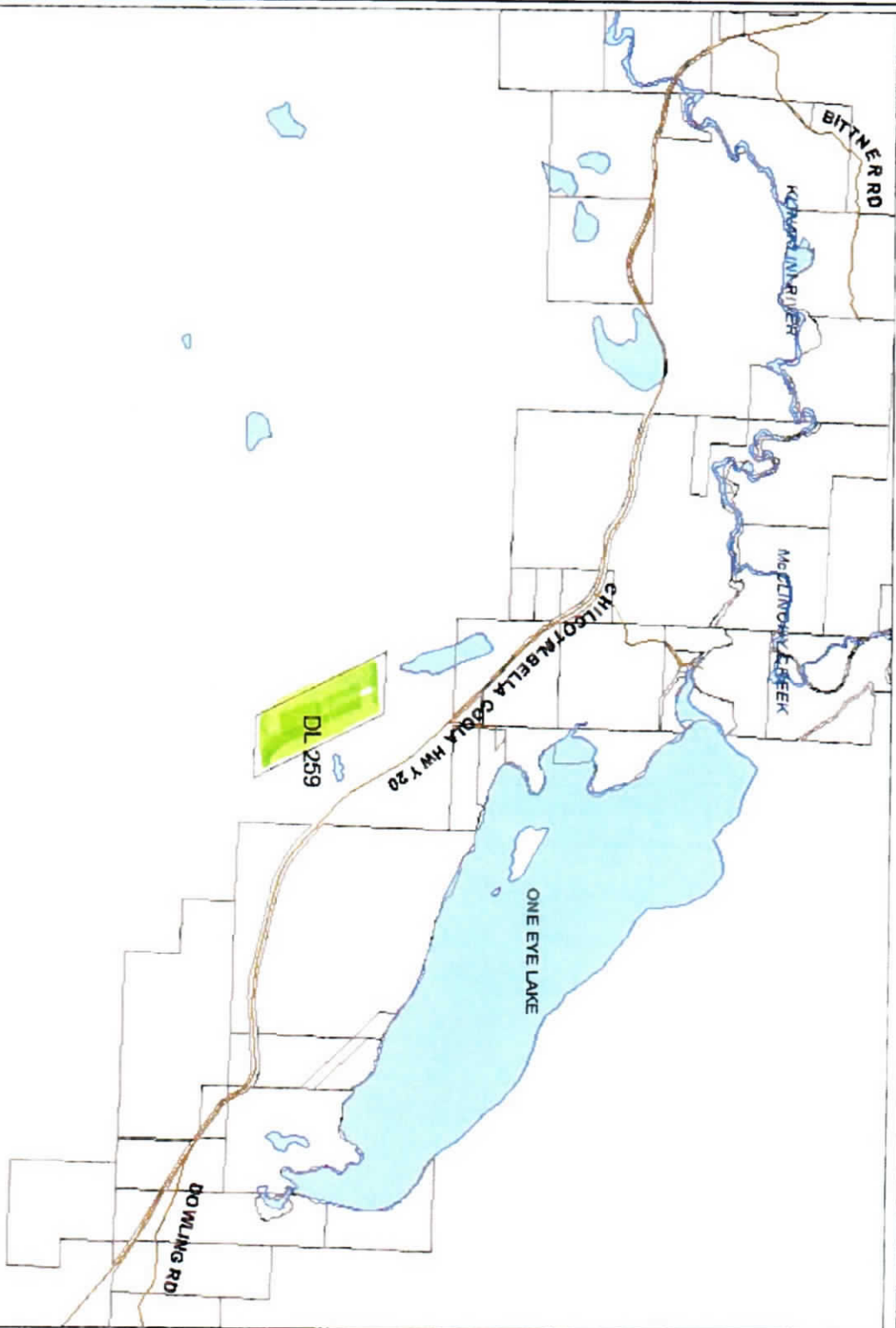

1.5 0 0.74 1.5 Miles

NAD_1983_UTM_Zone_10N
CRD GIS Department

1: 47,169



Legend

- Landfills and Transferstations
- LANDFILL
- TRANSFER STATION
- WOOD YARD
- 911 Roads
- Parcels
- EAs_And_Municipalities
- First Nations Reserves
- Rivers
- Lakes
- Parks and Protected Areas
- CaribooRD

Notes

Notes

This map is a user generated static output from an internet mapping site and is for reference only. Data layers that appear on this map may or may not be accurate, current, or otherwise reliable.

THIS MAP IS NOT TO BE USED FOR NAVIGATION

LOCATION OF THE KNOLL HOUSE

